

Logistec



Logistec

Electric High Capacity Pallet Jack with Initial Lift

Carrying Two Pallets at A Time Doubles Working Efficiency;
Extraordinary Traction in Crossing Door and Dock;
Long-tiller Design Makes Operations Easy and Convenient.

Performance



- The innovative AC system offers strong power, accurate control,excellent performance
- High strength vertical gearbox, longer working life
- Low-noise but durable hydraulic unit, good quality cylinder as well as hose ensure the high reliability of hydraulic system.
- AMP connector and durable electric wires greatly reduce malfunctions of components.
- H shape channel mast improves the strength of the whole truck.

Safety

- Safe hydraulic system design prevents mast from falling down abruptly when hydraulic pipeline cuts off.
- Emergency reverse belly button protects the operator from getting hurt.
- Emergency disconnecter will cut off power source to avoid accident when truck goes out of control.
- Multiple lifting limit protection ensures safety
- Automatic switch to lower speed when the fork reaches its setting height.
- Anti-rolling back brake keeps the truck from skidding down when truck is out of control or travelling on ramp.

Operation

- With the new design of ergonomical tiller head, all buttons can be reached conveniently & comfortably.
- Dual pallets lifting doubles working efficiency.
- Creep speed function: when handle in near vertical position, the driving speed will decrease automatically, allowing delicate operation in confined space.
- Long tiller decreases the operation forcegreatly and makes operations much easier.
- Bias Operation, Greater View.

Maintenance

- AC traction motor, maintenance free.
- Hour meter and battery indicator remind the operator of battery charging.
- Easily remove the back cover by only loosing two bolts; Access to all key components for inspection, maintenance and replacement.
- Easy access for battery maintenance.
- Vertical motor makes the inspection & service much more convenient.
- Mast and chassis are assembled together, easy for maintenance.
- Low voltage cut off setting protects batteries.

Specifications

Distinguishing mark	1.1	Manufacturer			Logistec (3381152)
	1.2	Model designation			Logistec Electric High Capacity Pallet Jack
	1.3	Drive			Electric
	1.4	Operator type			Pedestrain
	1.5	Rated capacity	q	kg	2000
Service Weight	1.6	Load center distance	c	mm	600
	1.8	Load distance, Centre of drive axel to fork	x	mm	905
	1.9	Wheelbase	y	mm	1441
Tyres/chassis	2.1	Service weight			625
	2.2	Axle loading, laden front/rear			910/1715
	2.3	Axle loading, unladen front/rear			420/205
	3.1	Tyre type driving wheels/loading wheels			Polyurethane/ Polyurethane
	3.2	Tyre size, driving wheels			Φ230 x 75
Dimensions	3.3	Tyre size, loading wheels			Φ85 x 70
	3.4	Tyre size, caster wheels			Φ85 x 48
	3.5	Wheels, number driving caster/loading (x=drive wheels)			1x +2/4
	3.6	Track width, front,driving side	b10	mm	498
	3.7	Track width,rear,loading side	b11	mm	366
	4.4	Lift	h3	°	540
	4.6	Initial lift	h5	mm	120
	4.9	Height drawbar in driving position min./max.			715/1200
	4.15	Lowered height			95
	4.19	Overall length			1850
Performance data	4.20	Length to face of forks			694
	4.21	Overall width			710
	4.22	Fork dimensions			60/190/1150
	4.25	Outside w idth of the forks			560
	4.32	Ground clearance, center of wheelbase			30
Electric-engine	4.34.1	Aisle width for pallets 1000 × 1200 crossways			1913
	4.34.2	Aisle width for pallets 800 × 1200 lengthways			2113
	4.35	Turning radius			1615
	5.1	Travel speed, laden/unladen			5/5.5
	5.2	Support arm Lifting speed, laden/ unladen			0.024/0.025
Addt-data	5.21	Mast lifting speed, laden/unladen			0.071/0.121
	5.3	Support arm Lowering speed, laden/ unladen			0.050/0.032
	5.31	Mast Lifting speed, laden/ unladen			0.13/0.1
	5.8	Max. gradeability, laden/unladen			8/16
	5.10	Service brake type			Electromagnetic
Addt-data	6.1	Drive motor rating S2 60 min			1.27
	6.2	Lift motor rating at S3 15%			0.84
	6.3	The Maximum allowd size battery			650 x 150 x 625
	6.4	Battery voltage/hominal capacity K5			24/150
	6.5	Battery weight			140
Addt-data	8.1	Type of drive unit			AC
	10.5	Steering design			Mechanical
	10.7	Sound pressure level at the driver's ear			74

If there are improvements of technical parameters or configurations, no further notice will be given.
The diagram shown may contain non-standard configurations.

Options

No.	Option items	Logistec Electric High Capacity Pallet Jack
	Fork length	○ 1150 mm
	Double load wheel	●
	Single load wheel	●
	Driving Wheel	● PU
	Balance wheel	●
	Battery capacity	○ 180Ah
	Battery indicator without hour meter	○
	Battery indicator with hour meter	●
	Water auto-filling system	○
	Special backrest	○ 1200mm / 1520mm
Note ●Standard ○Optional - n/a		

Rated Capacities Graph

Product Image	Mast Fork "A" / "B"	Lift Height	Capacity (kg)
	Mast Fork "A"	630	650
	Mast Fork "B"	210	A+B<2000

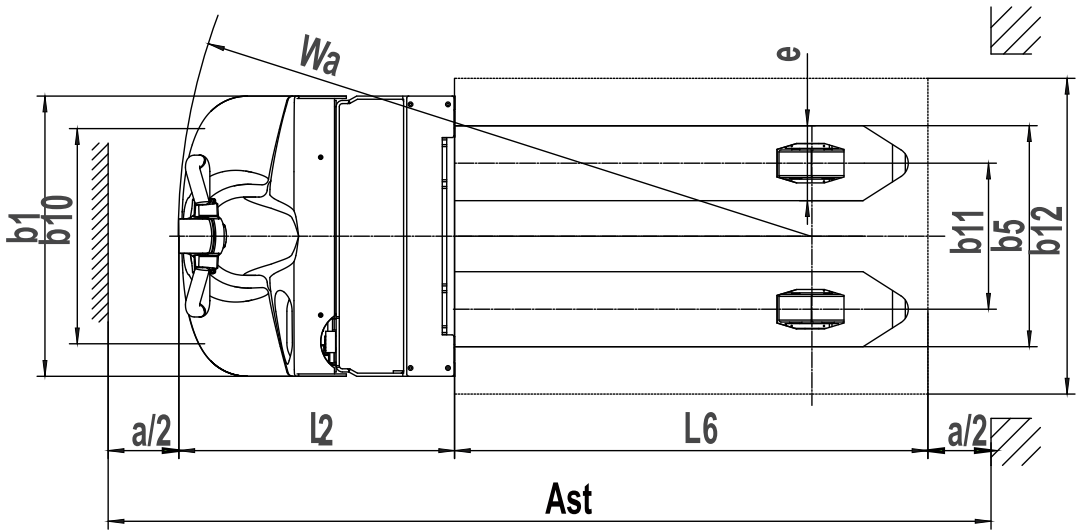
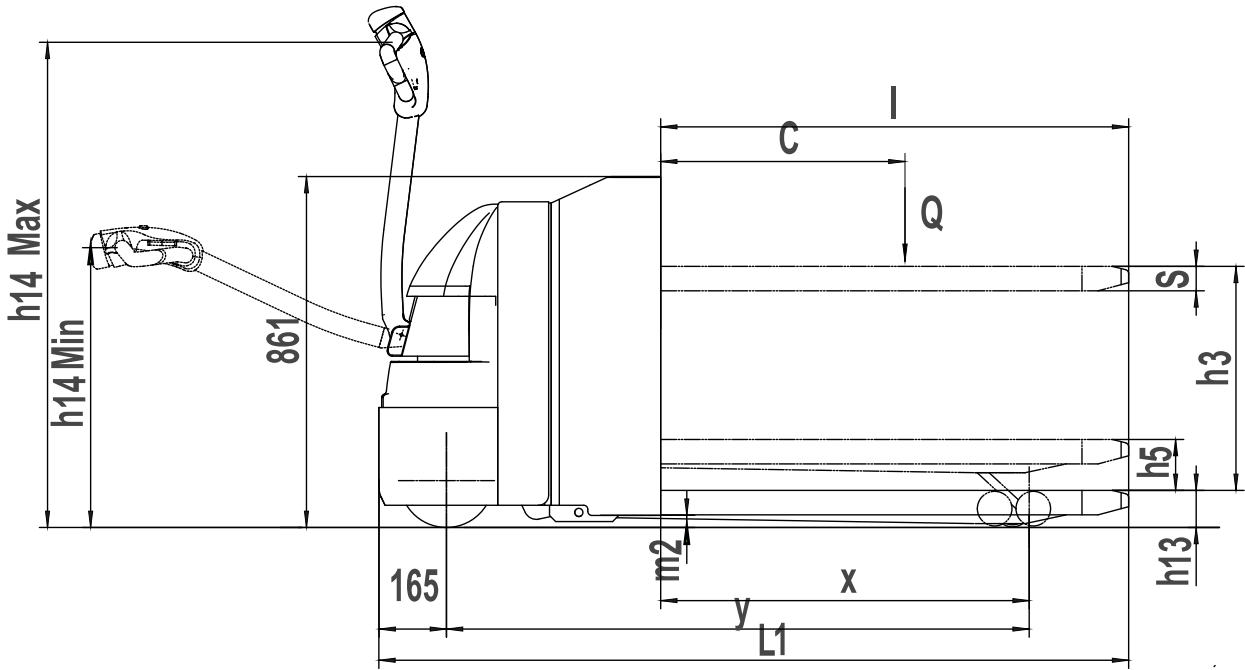



www.sitecraft.net.au | 1300 363 152 | sales@sitecraft.com.au